

# ANCHOR CHAIN FITTINGS

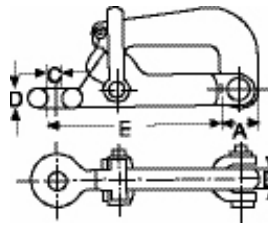

## PELICAN HOOKS

Chain Size (mm)	A (mm)	B (mm)	C (mm)	D (mm)	E (mm)	S.W.L (tonnes)	Weight (kg)
25-28	90	35	38	30	358	10	24
32	100	40	45	35	390	15	35
34-42	110	45	55	42	430	25	50
44-48	120	50	60	50	475	35	70
51-58	135	60	75	60	525	50	98
60-64	150	70	86	70	600	60	150
67-70	170	80	90	80	705	75	230
76-83	200	100	105	100	880	100	430

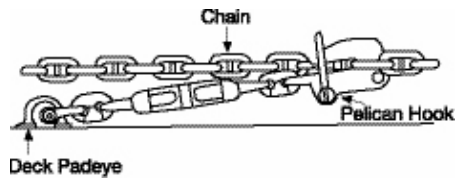
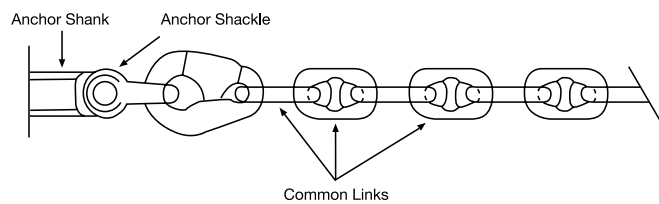
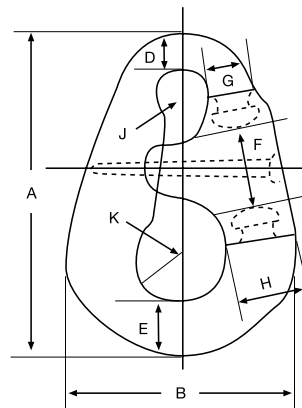
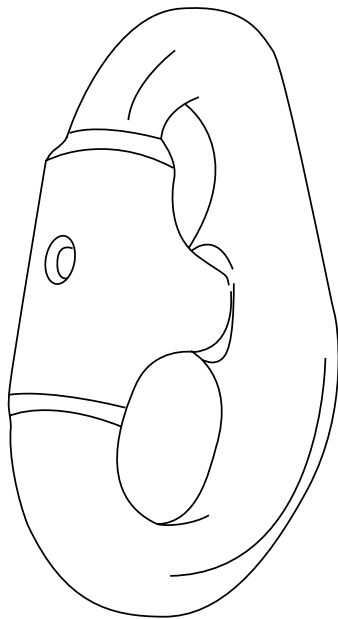

## PEAR LINKS

Model	Chain Size (mm)	Dimensions (mm)									Weight (kg)
		A	B	D	E	F	G	H	J	K	
4	32-40	298	207	41	50	89	45	60	26	41.5	13
5	42-51	380	264	52	65	100	60	84	32.5	54.5	27
6	52-60	480	337	66	83	125	81	103	43	71	49
7	62-79	570	370	85	96	155	92	113	49	70	94
8	81-92	655	430	99	129	162	119	131	57.5	81	149
9	94-95	692	435	98	130	159	137	141	57	83	236
10	97-102	900	580	127	168	192	151	181	75	103.5	386

